

NOTES

- 1) 180° F (82° C) MAXIMUM TEMPERATURE.
- 2) CCW-500 MUST CONTACT FLASHING AND DECK MEMBRANE.
- 3) DECK FLANGE MUST BE CONTINUOUS WITH ROUNDED CORNERS.
- 4) CCW-500 POCKET MAY BE ROUND.
- 5) CCW-500 POCKET TO BE 1 IN. (25 cm) MIN. FROM PENETRATION ON ANY SIDE.
- 6) CCW-500 MUST COMPLETELY FILL CCW-500 POCKET TO PREVENT PONDING OF WATER.
- 7) CCW-500 TO BE MIN. 2 IN. (5 cm) DEEP.
- 8) CCW-500 MUST CONTACT THE BARE SURFACE OF THE PENETRATION – ALL DEBRIS (PAINT, RUST, LEAD, OTHER FLASHING, ETC.) MUST BE REMOVED FROM THE PENETRATION.

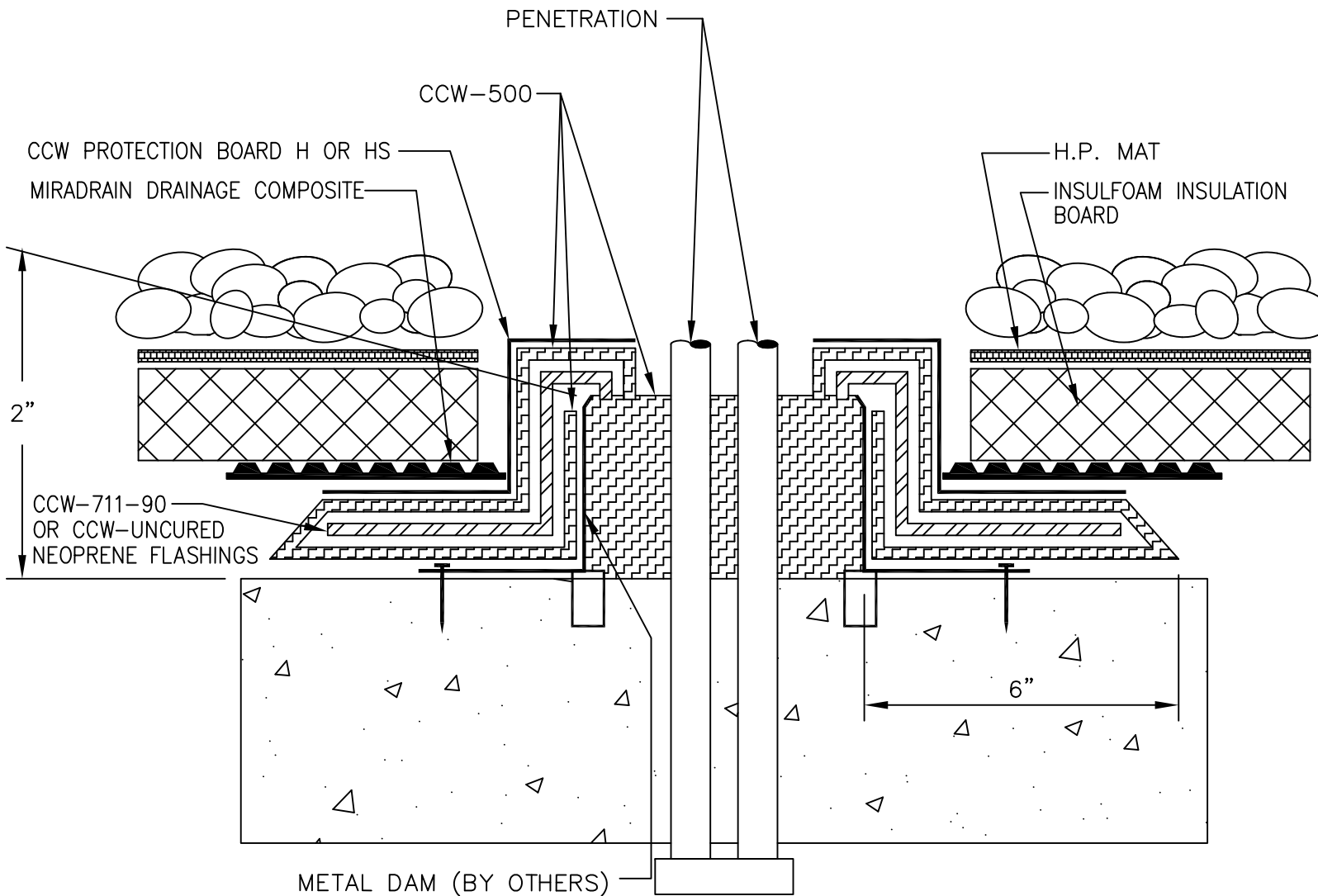

500-16

FIELD FABRICATED
CCW-500 POCKET

CARLISLE

© 2011 CARLISLE CORPORATION