

## NOTES

- 1) MEMBRANE SPLICING PROCEDURE IS FOR THE SPLICES BETWEEN CLEAN CURED EPDM MEMBRANE AND CCW-500.
- 2) VERTICAL EPDM SPLICES SHALL BE OVERLAID WITH 6" WIDE ELASTOFORM® FLASHING.
- 3) APPLY SPLICING CEMENT OVER ENTIRE 6" MIN SPLICE AREA OF THE CLEANED CURED EPDM AND ELASTOFORM OVERLAY PRIOR TO THE APPLICATION OF CCW-500
- 4) INSTALL CCW PROTECTION BOARD-H OR HS
- 5) INSTALL MIRADRAIN DRAINAGE COMPOSITE.

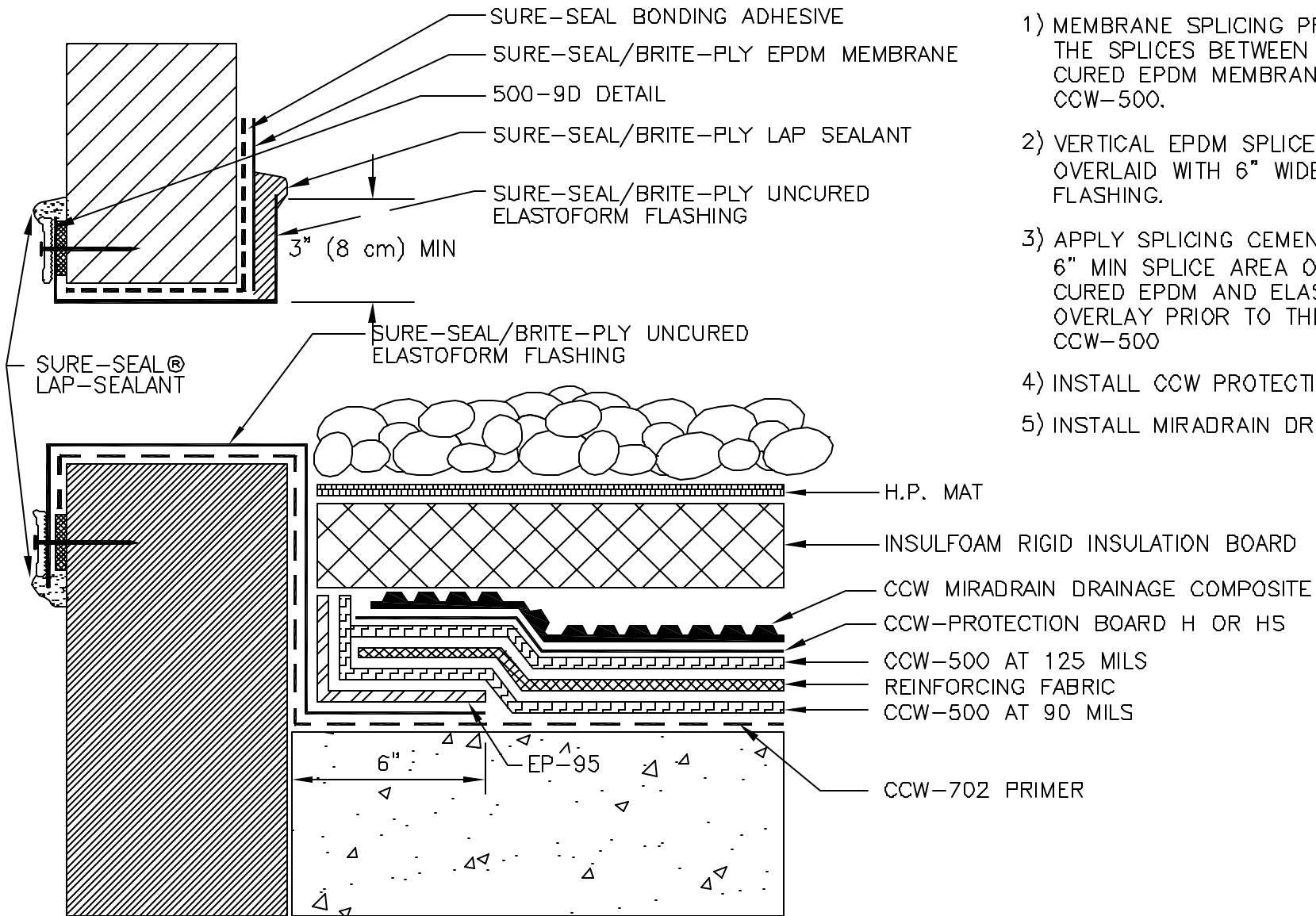

500-18A

OVERFLOW SCUPPER

**CARLISLE**

© 2008 CARLISLE CORPORATION