

## NOTES

- 1) BALLAST RETAINING BAR MUST EXTEND ABOVE GRAVEL SURFACE SUFFICIENTLY TO RETAIN GRAVEL AND PREVENT GRAVEL MIGRATION.
- 2) REFER TO LOCAL CODES FOR PROPER DRAINAGE
- 3) SLOTS IN BALLAST RETAINING BAR MUST BE FLUSH OR BELOW MEMBRANE LEVEL.

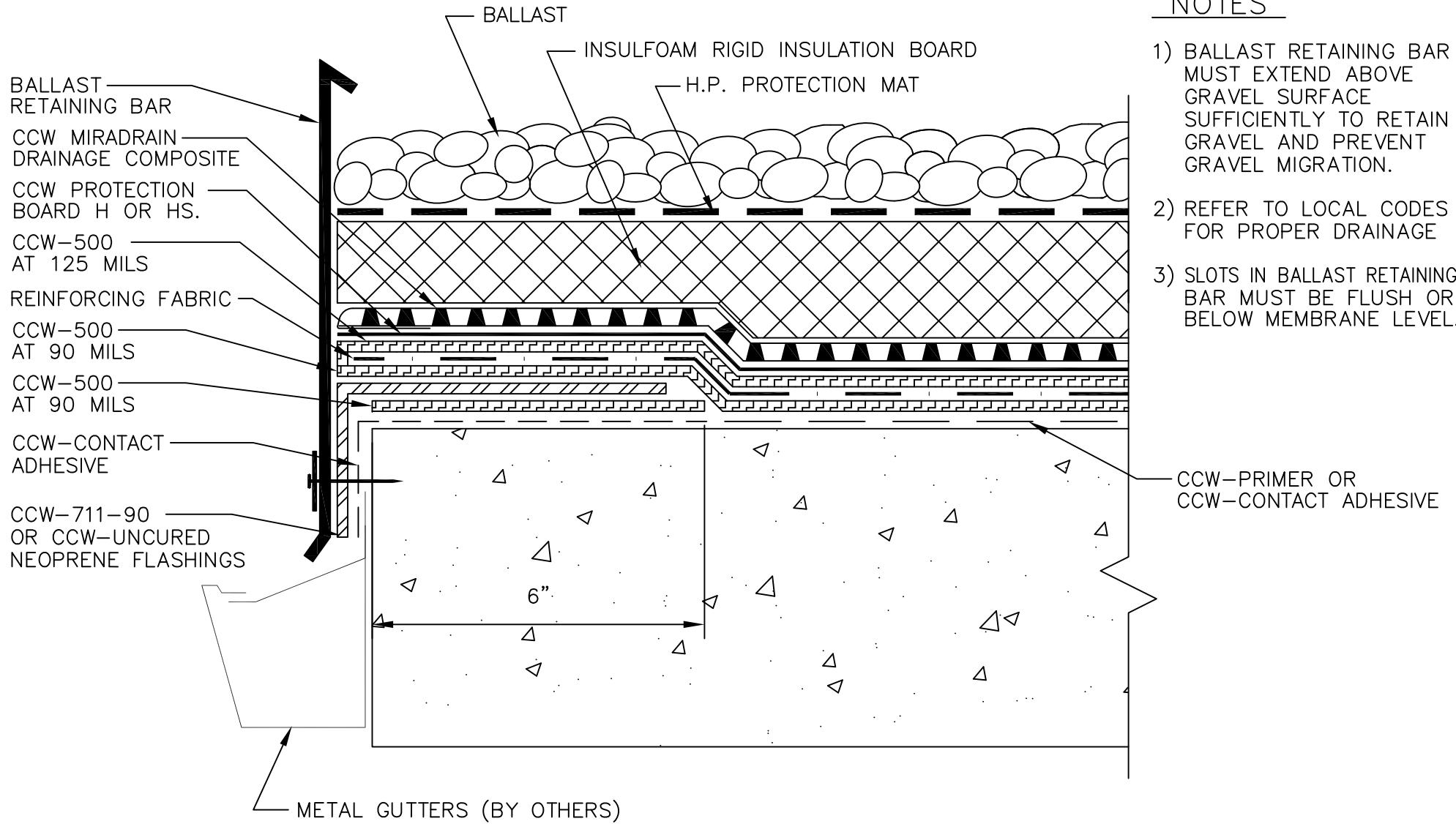

500-2A

BALLAST RETAINING  
BAR

**CARLISLE**

© 2011 CARLISLE CORPORATION