

CCW-703-V LIQUISEAL®
 CCW-201 SEALANT OR
 CCW-704 MASTIC

STAINLESS STEEL
 PIPE CLAMP

CCW PROTECTION BOARD
 H OR HS

CCW-201

CCW MIRADRAIN

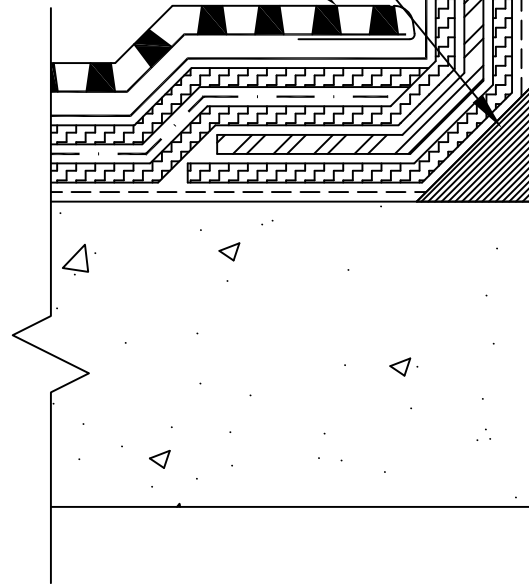

TERMINATION OF SHEET FLASHING ON
 VERTICAL PENETRATIONS SHALL BE BELOW
 THE FINISH COURSE.

CCW-550 PRIMER

90 MILS OF CCW-500

CCW-711-90 FLASHING

125 MILS OF CCW-500

CCW-500 REINFORCING
 FABRIC

90 MILS OF CCW-500

CCW-PRIMER OR
 CCW-CONTACT ADHESIVE

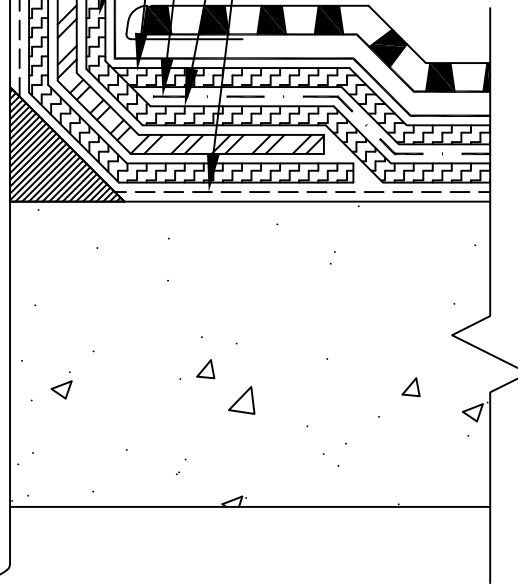

AN ALTERNATE DETAIL IS TO USE A
 PRE-FORMED "BOOT" IN LIEU OF SEALANT
 AND SHEET FLASHING. REFER TO BOOT
 MANUFACTURER'S INSTRUCTIONS

NOTES

- 1) INSTALL CCW-201 SEALANT. TOOL SEALANT TO FORM A 1 1/2" X 1 1/2", 45 DEGREE CANT. LET CURE OVER NIGHT.
- 2) APPLY CCW-PRIMER OR CCO-CONTACT ADHESIVE. APPLY CCW-500R HOT APPLIED MEMBRANE.
- 3) INSTALL CCW-711-90 FLASHING. AND CLAMPING RING TO SPECIFIED HEIGHT AND 4" MIN. ONTO CURED CCW-500.
- 4) APPLY CCW-500 HOT APPLIED MEMBRANE OVER CCW-711-90 FLASHING
- 5) INSTALL CCW PROTECTION BOARD-H OR HS.
- 6) INSTALL CCW MIRADRAIN DRAINAGE COMPOSITE

500-8A

PIPE AND
 PENETRATION FLASHING

CARLISLE

© 2011 CARLISLE CORPORATION