

CCW MIRADRAIN \_\_\_\_\_  
 CCW MIRADRI 860/861 \_\_\_\_\_  
 CCW-PRIMER \_\_\_\_\_  
 CCW-LM-800XL OR \_\_\_\_\_  
 CCW-201 CANT WITH \_\_\_\_\_  
 3/4" MIN. FACE \_\_\_\_\_  
 CCW-LM-800XL OR \_\_\_\_\_  
 CCW-201 CANT WITH \_\_\_\_\_  
 3/4" MIN. FACE \_\_\_\_\_  
 SURE-SEAL EP-95 SPLICING \_\_\_\_\_  
 CEMENT OR HP-250 AND \_\_\_\_\_  
 SURE-SEAL SECURE-TAPE \_\_\_\_\_  
 SURE-SEAL LAP \_\_\_\_\_  
 SEALANT \_\_\_\_\_

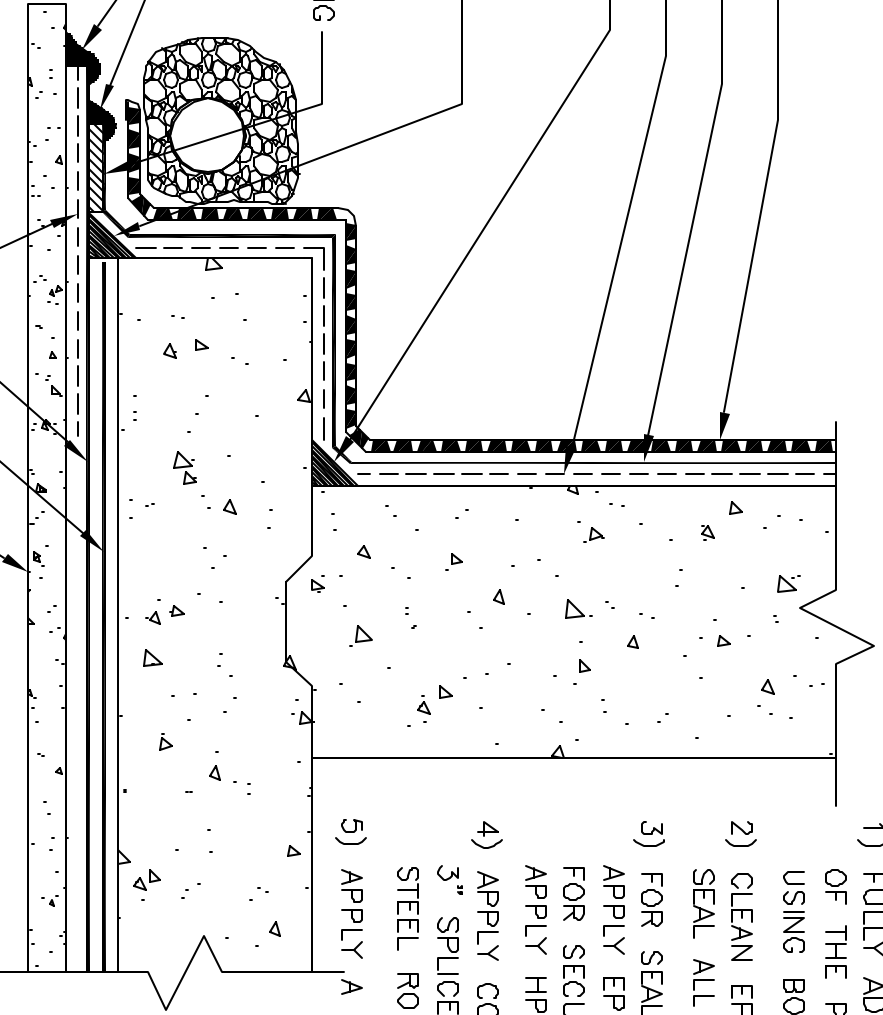

SURE SEAL BONDING ADHESIVE \_\_\_\_\_  
 SURE-SEAL EPDM \_\_\_\_\_  
 CCW PROTECTION BOARD-H OR \_\_\_\_\_  
 CCW-300HV PROTECTION FABRIC \_\_\_\_\_  
 CONCRETE MUD SLAB \_\_\_\_\_

NOTE:

- 1) FULLY ADHERE EPDM TO THE OUTER 2' OF THE PERIMETER OF THE SUBSTRATE USING BONDING ADHESIVE
- 2) CLEAN EPDM SPLICE AREA WITH SURE-SEAL ALL PURPOSE MEMBRANE CLEANER
- 3) FOR SEALANT SPLICE:  
 APPLY EP-95 TO SPLICE AREA OF EPDM FOR SECURE-TAPE SPLICE:  
 APPLY HP-250 AND APPLY SECURE-TAPE
- 4) APPLY CCW MIRADRI 860 WITH A MINIMUM 3" SPLICE OVERLAP. ROLL SPLICE WITH STEEL ROLLER
- 5) APPLY A BEAD OF LAP SEALANT

860-7B

FOUNDATION/SLAB TIE-IN



© 2009 CARLISLE CORPORATION